

Silenziatore conico in bronzo sferico sinterizzato ribattuto su base ottone con taglio cacciavite.

Filettatura GAS-BSP

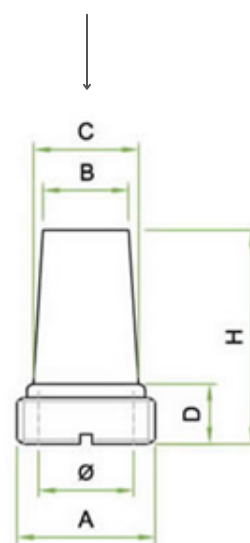

Bronzo sinterizzato
Sintered bronze
Sinterbronze



base ottone
brass base

Tipologia	codice	articolo	A	DIAM	B	C	D	H
STCC	208	STCC 1/8	1/8"	5,5	3,5	4,5	5,0	15,0
STCC	209	STCC 1/4	1/4"	7	4,5	6,0	6,0	18,0
STCC	210	STCC 3/8	3/8"	9,5	8,0	9,0	7,0	21,0
STCC	211	STCC 1/2	1/2"	12,5	9,5	11,0	8,0	27,0
STCC	212	STCC 3/4	3/4"	19	16,0	18,0	8,0	36,0
STCC	213	STCC 1	1"	24	22,0	25,0	10,0	48,0

Unità di misura espressa in millimetri.