

SCC

Silenziatore in bronzo sferico sinterizzato su base circolare in acciaio ramato. Filettatura GAS-BSP.
Silencer with slotted spherical bronze sintered on a circular copper-plated steel GAS-BSP thread

CARATTERISTICHE / FEATURES

Fluido: Aria
 Filtrazione: 50
 Pressione d'esercizio: 1 MPa 10 bar
 Temperatura d'esercizio -20 ° C + 150° C
 Raccordo: Acciaio ramato
 Filettatura: GAS-BSP rif. UNI EN ISO 228-1:2003

Bronzo sinterizzato / Sintered bronze
 AF 50 DIN 30 910 T2 CuSn10

Acciaio ramato / Copper plated
 115 Mn Pb 37 UNI EN 10277 Trattamento - Ramatura CuCn

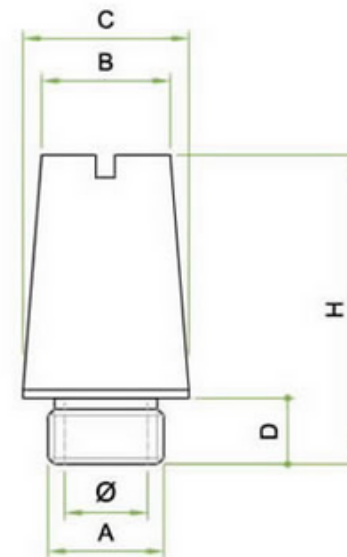

Unità di misura espressa in millimetri./ Unit of measurement expressed in millimeters. - tolleranze rif. normativa En-22768 ISO-2768-c

Codice	Articolo	A	Diam	B	C	D	H
190	SCC 1/8	1/8"	7,0	9,0	11,5	4,5	22,0
191	SCC 1/4	1/4"	9,5	12,5	15,0	6,0	26,0
192	SCC 3/8	3/8"	13,0	15,5	19,0	7,0	34,5
193	SCC 1/2	1/2"	16,0	18,5	23,0	8,0	43,0
194	SCC 3/4	3/4"	22,0	24,5	30,0	9,0	50,0
195	SCC 1	1"	28,0	31,0	37,0	11,0	60,5

SCC

Livello di rumore / noise level dB 6 BAR

1/8	1/4	3/8	1/2	3/4	1
70	67	77	80	84	85

Livello di rumore / noise level dB 4 BAR

1/8	1/4	3/8	1/2	3/4	1
68	65	75	76	80	82

Prove di flusso / flow test
