

SIE

Silenziatore integrale in bronzo sferico sinterizzato con base esagonale.

Integral silencer with bronze spherical sintered hexagonal base.



CARATTERISTICHE / FEATURES

Fluido: Aria
 Filtrazione: 50
 Pressione d'esercizio: 1 MPa 10 bar
 Temperatura d'esercizio -20 ° C + 150° C
 Filettatura: GAS-BSP rif. UNI EN ISO 228-1:2003

Bronzo sinterizzato / Sintered bronze
 AF 50 DIN 30 910 T2 CuSn10

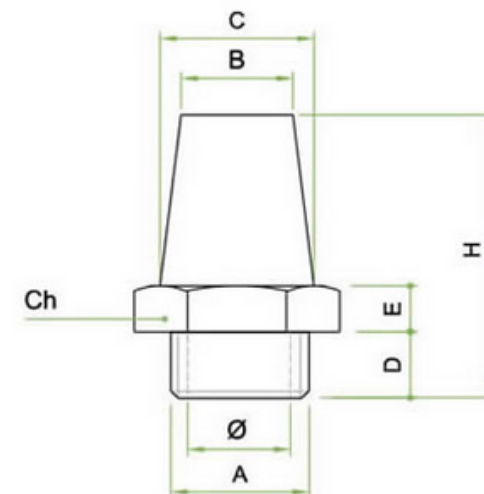

Unità di misura espressa in millimetri - tolleranze rif. normativa En-22768 ISO-2768-c . Misura ch +0/-0.10 mm

Codice	Articolo	A	Diam	B	C	D	E	H	Ch
196	SIE 1/8	1/8"	4,0	8,0	10,0	6,0	4,0	28,0	13,0
197	SIE 1/4	1/4"	6,0	12,0	14,0	8,0	4,0	34,0	17,0
198	SIE 3/8	3/8"	9,0	15,0	17,0	10,0	5,0	36,0	22,0
199	SIE 1/2	1/2"	12,0	19,0	20,5	12,0	7,0	44,0	27,0
200	SIE 3/4	3/4"	16,0	22,0	25,0	14,0	10,0	54,0	32,0
201	SIE 1	1"	22,0	28,0	31,0	16,0	10,0	66,0	41,0