

SREX

Silenziatore con cupola in filo inox AISI 316L ribattuto su base esagonale in acciaio inox AISI 316L - Filettatura GAS-BSP

Silencer-dome stainless steel wire AISI 316L countered on a hexagonal stainless steel AISI 316L - Filettatura GAS-BSP



CARATTERISTICHE / FEATURES

Fluido: Aria

Filtrazione: 70

Pressione d'esercizio: 1 MPa 10 bar

Temperatura d'esercizio -50° C + 400° C

Filettatura: GAS-BSP rif. UNI EN ISO 228-1:2003

(*) Gli articoli con codici M hanno la filettatura Metrica

Acciaio Inox AISI 316L
X2CrNiMo17-12-2 UNI EN 10088-3

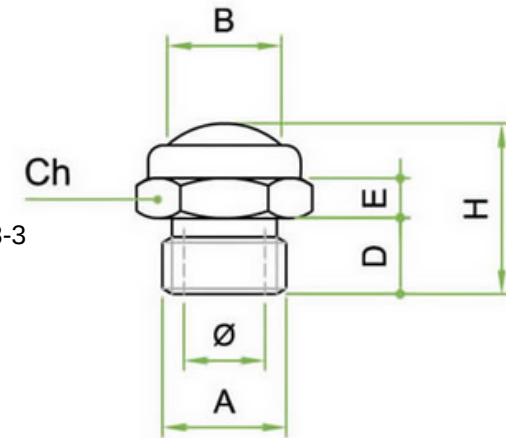

Unità di misura espressa in millimetri - tolleranze rif. normativa En-22768 ISO-2768-c

SCIP N. facb8fe7-60e3-4d35-93fd-d99bcb1fae7b

Codice	Articolo	A	Diam	B	D	E	H	Ch
300	SREX M 5	M5	2,5	5,0	4,0	3,0	8,0	8,0
301	SREX 1/8	1/8"	6,0	9,5	6,0	4,0	14,0	13,0
302	SREX 1/4	1/4"	8,5	12,0	8,0	5,0	18,0	16,0
303	SREX 3/8	3/8"	11,5	14,5	8,0	5,0	19,0	19,0
304	SREX 1/2	1/2"	15,0	19,0	10,0	6,0	22,0	24,0
305	SREX 3/4	3/4"	20,0	25,0	10,0	5,0	24,0	30,0
306	SREX 1	1"	26,0	31,0	10,0	5,0	27,5	36,0
308	SREX 1 ½	1 ½"	40,0	42,0	12,0	7,0	31,0	52,0
309	SREX 2	2"	50,0	53,0	20,0	9,0	40,0	65,0

SREX

Livello di rumore / noise level dB 6 BAR

1/8	1/4	3/8	1/2	3/4	1
74	72	88	90	90	92

Livello di rumore / noise level dB 4 BAR

1/8	1/4	3/8	1/2	3/4	1
70	69	85	85	86	88

Prove di flusso / flow test
