

SRZ

Silenziatore con cupola in filo inox AISI 304 ribattuta su base circolare zigrinata. Filettatura GAS-BSP

Silencer-dome wire AISI 304 stainless riveted on a circular knurled brass- GAS-BSP thread

CARATTERISTICHE / FEATURES

Fluido: Aria
 Filtrazione: 70
 Pressione d'esercizio: 1 MPa 10 bar
 Temperatura d'esercizio -20 ° C + 150° C
 Tolleranze: ISO 2768 C

Acciaio Inox AISI 304L
 X2CrNi18-11 UNI EN 10088-1

Ottone / Brass
 CW 614 N UNI EN 12164 CuZn39Pb

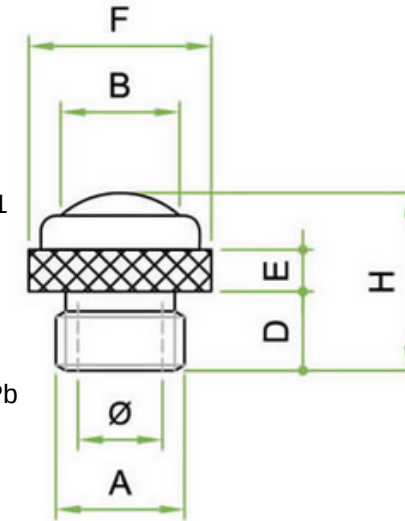

Unità di misura espressa in millimetri./ Unit of measurement expressed in millimeters.

Codice	Articolo	A	Diam	B	D	E	F	H
135	SRZ 1/8	1/8"	6,0	9,5	7,0	4,0	13,0	14,0
136	SRZ 1/4	1/4"	8,5	11,0	8,0	4,5	16,0	18,0
137	SRZ 3/8	3/8"	11,5	14,5	8,0	5,0	19,0	20,0
138	SRZ 1/2	1/2"	15,0	19,0	10,0	5,0	24,0	22,0
139	SRZ 3/4	3/4"	20,0	24,0	10,0	5,0	30,0	24,0
140	SRZ 1	1"	26,0	31,0	10,5	6,0	38,0	27,0

SRZ

Livello di rumore / noise level dB 6 BAR

1/8	1/4	3/8	1/2	3/4	1
74	72	88	90	90	92

Livello di rumore / noise level dB 4 BAR

1/8	1/4	3/8	1/2	3/4	1
70	69	85	85	86	88

Prove di flusso / flow test
